

Furniture - Room Key

- Tenanted Offices
- Council Offices
- Cafeteria

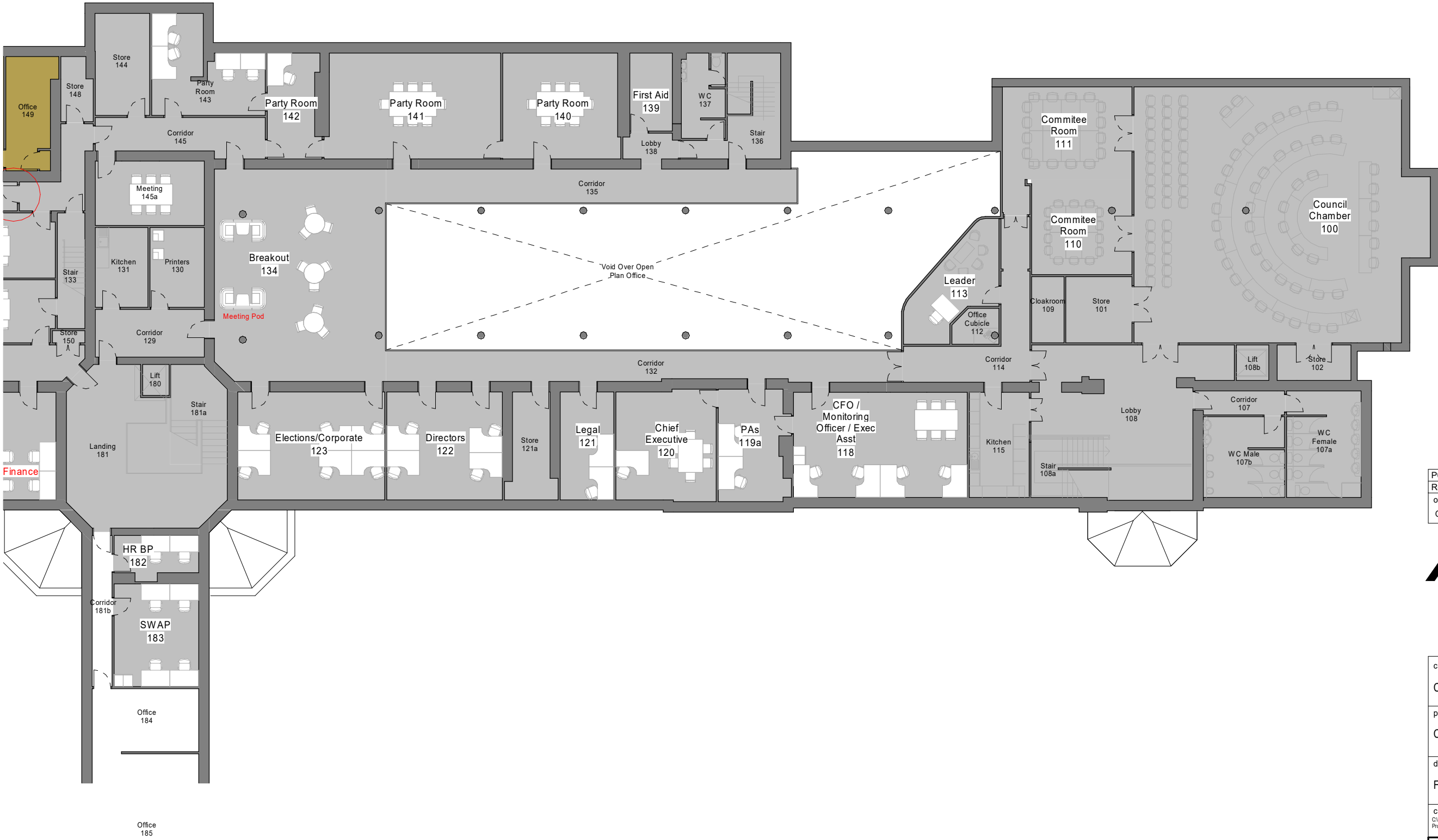

Level 1 - Furniture Layouts Opt1b - East

| | | | | |
|-------------|--------------|-------------|-------|--------|
| P01 | First Issue | 03.02.22 | GE | SO |
| Rev | Description | Date | Dr by | App by |
| original by | date created | approved by | | |
| GE | 01/10/22 | SO | | |

AHR

AHR Architects Ltd
Vinty Building
Wine Street
Bristol
BS1 2BD
United Kingdom

T +44(0)117 9299146
E bristol@ahr.co.uk
www.ahr.co.uk

| | | |
|---|-------------|--------------|
| client name | | |
| Cotswold District Council | | |
| project | | |
| Cotswold DC, Trinity Rd Offices | | |
| drawing | | |
| First Floor East - Furniture Layout Opt1b | | |
| computer file | | plot date |
| C:\Revit Projects\00373.000-AHR-TR-XX-M3-A-CENTRAL_stave.osullivan.rvt | | |
| project number | scale | |
| 2021.00373.000 | 1 : 200 @A3 | |
| drawing number | rev | issue status |
| CDC-AHR-ZE-01-DR-A-82-100b | P01 | S2 |

This drawing is to be read in conjunction with all related drawings. All dimensions must be checked and verified on site before commencing any work or producing shop drawings. The originator should be notified immediately of any discrepancy. This drawing is copyright and remains the property of AHR.

